

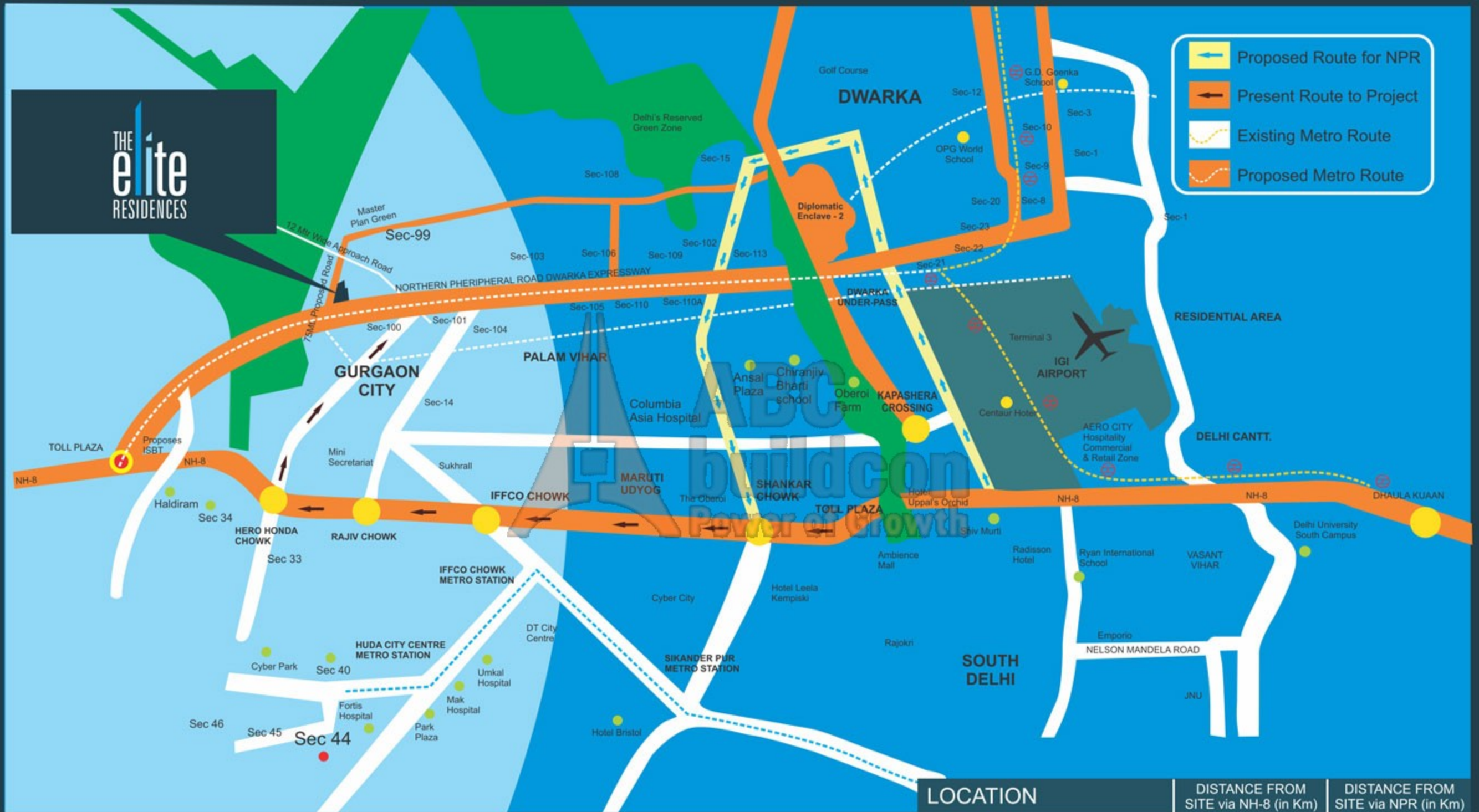

+918470930121 | [www.abcbuildcon.in](http://www.abcbuildcon.in)

# LOCATION MAP



**THE elite RESIDENCES**

- Proposed Route for NPR
- Present Route to Project
- Existing Metro Route
- Proposed Metro Route

LOCATION	DISTANCE FROM SITE via NH-8 (in Km)	DISTANCE FROM SITE via NPR (in Km)
NEW DELHI RAILWAY STATION	43	36
IGI AIRPORT	26	12
DWARKA	23	09
HUDA CITY CENTRE	14	14
GURGAON ISBT	10	10
GURGAON RAILWAY STATION	09	09



ABC  
buildcon  
Power of Growth

+918470930121 | [www.abcbuildcon.in](http://www.abcbuildcon.in)



75M WIDE DRIVEWAY

6M WIDE DRIVEWAY

RAMP

RAMP

12M WIDE SERVICE ROAD

18M MASTER GREEN

150 MTS Dwarka Expressway

12M WIDE SERVICE ROAD

+918470930121 | www.abcbuildcon.in



### LEGEND

- 1) POOL
- 2) CLUB
- 3) LAWN
- 4) SHOPPING CENTRE
- 5) EWS
- 6) AMPHITHEATRE
- 7) KIDS PLAY AREA
- 8) BASKETBALL COURT
- 9) TENNIS COURT
- 10) BADMINTON COURT



ABC  
buildcon  
Power of Growth

+918470930121 | [www.abcbuildcon.in](http://www.abcbuildcon.in)

3BHK  
AREA: 1865 SQ.FT.



3BHK  
AREA: 2150 SQ.FT.



THE elite RESIDENCES

3BHK  
AREA: 2173 SQ.FT.

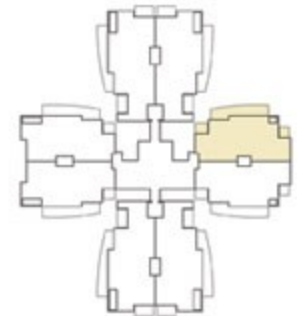

BLOCK PLAN

UNIT PLAN

+918470930121 | [www.abcbuildcon.in](http://www.abcbuildcon.in)



4BHK  
AREA: 2365.00 SQ.FT.





ABC  
Buildcon  
Power of Growth

+918470930121 | [www.abcbuildcon.in](http://www.abcbuildcon.in)

THE  
**elite**  
RESIDENCES

3BHK  
AREA: 2473 SQ.FT.

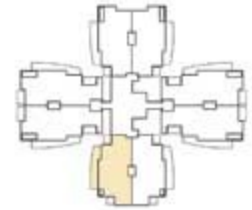

BLOCK PLAN

UNIT PLAN

+918470930121 | [www.abcbuildcon.in](http://www.abcbuildcon.in)

4BHK  
AREA: 2799.00 SQ.FT.



THE elite RESIDENCES

4BHK  
AREA: 3144 SQ.FT.

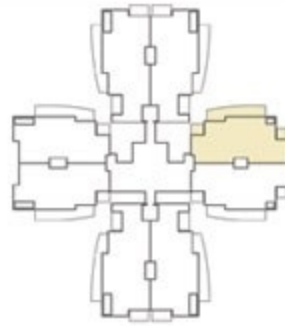

BLOCK PLAN

THE elite RESIDENCES

4BHK



+918470930121 | [www.abcbuidcon.in](http://www.abcbuidcon.in)

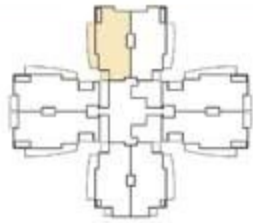

BLOCK PLAN



PENT HOUSE LOWER LEVEL



PENT HOUSE UPPER LEVEL

4BHK  
AREA: 3710.00 SQ.FT.

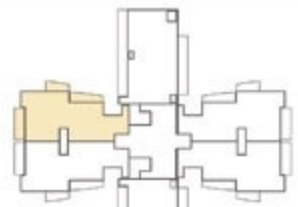

BLOCK PLAN



PENT HOUSE LOWER LEVEL

4BHK

BALCONY BELOW



PENT HOUSE UPPER LEVEL



ABC  
buildcon  
Power of Growth

+918470930121 | [www.abcbuildcon.in](http://www.abcbuildcon.in)



<b>BSP</b>	<b>As Applicable</b>
------------	----------------------

<b>Additional Charges</b>	
EDC & IDC	Rs 370/- Per Sq.Ft.
Interest Free Maintenance & Security (IFMS)	Rs 50/- Per Sq.Ft.
Fire Fighting Charges (FFC)	Rs 30/- Per Sq.Ft.
Club Membership Charges (CMC)	Rs 1,00,000/- per unit

<b>Car Parking</b>	
Basement	Rs 2,50,000/- each
Stilt	Rs 2,75,000/- each
Open	Rs 1,50,000/- (only as second parking)

<b>Preferential Location Charges (PLC)</b>	
Podium Floor	Rs 300/- Per Sq.Ft.
First Floor	Rs 150/- Per Sq.Ft.
Second Floor	Rs 125/- Per Sq.Ft.
Third Floor to Fifth Floor	Rs 75/- Per Sq.Ft.
Club & Garden Facing	Rs 125/- Per Sq.Ft.
Corner	Rs 100/- Per Sq.Ft.
Sector Road Facing	Rs 100/- Per Sq.Ft.

<b>Other Charges</b>	
Electric Connection Charges	As per Actuals (at the time of connection)
Power Back Up	Rs 1,00,000/- upto 4KVA
Additional KVA	Rs 25,000/- per KVA

<b>Booking Amount</b>		
Apartment Type	Size (Sq.Ft.)	Amount (Rs In Lacs)
3BHK	1,865	11
3BHK+SQ	2,150	12.5
4BHK +SQ	2,365	14
Podium	2173, 2473, 2799	15
Penthouses	3144, 3505, 3710	20

## Milestone Linked Payment Plan

Milestone	Percentage of BSP	Percentage of Additional Charges
On Booking	Booking Amount	
Within 4 months from the Booking or Completion of Basement Slab whichever is later	20% Of BSP less Booking Amount	
Within 8 months from the Booking or Completion of 3rd Floor Slab whichever is later	10% Of BSP	
Within 12 months from the Booking or Completion of 8th Floor Slab whichever is later	10% Of BSP	100% of (EDC & IDC + PLC)
Within 18 months from the Booking or Completion of Top Floor Slab whichever is later	15% Of BSP	50 % of Car Parking
Within 24 months from the Booking or Completion of Brick Work & Internal Plaster whichever is later	15% Of BSP	50 % of Car Parking
On offer of Possession	30% Of BSP	100% of (Club Membership +IFMS+FFC+Other Charges+ Stamp Duty & Registration Charges)

## Down Payment Plan (DPP)

Stages	Percentage of BSP	Percentage of Additional Charges
On Booking	Booking Amount	
On or Before 45 Days from Booking	95% of BSP less Booking Amount	100% of (EDC & IDC+ PLC + Car Parking Charges)
On offer of Possession	5% Of BSP	100% of (Club Membership +IFMS+FFC+Other Charges+Stamp Duty & Registration Charges)
Down Payment Rebate	10% on (85% of BSP + 100% of PLC)	

### Notes

- All cheques / Demand Drafts to be made in Favour of "Pareena Infrastructures Pvt. Ltd".
- Prices are subject to revision/withdrawal without notice at company's sole discretion.
- Service tax shall be payable as per the Government rules and regulations.
- Stamp Duty, Registration Charges, Legal/miscellaneous expenses etc., shall be payable by the Allottee at the time of offer of possession based on the then prevailing rates.
- In case of any revision in EDC & IDC (External Development Charges & Infrastructure Development Charges) made by the State Govt. effective from any retrospective date and applicable on this project shall be binding on all the buyers and accordingly EDC & IDC charge will be applicable as per the revised rate.
- Prices, terms and conditions stated herein are merely indicative with a view to acquaint the applicant and are not exhaustive. For finalized terms and conditions please refer to the application form.