

Type	Super Builtup Area	Accommodation
A	1730 sq.ft.	3BHK+3T
B	1465 sq.ft.	2BHK+2T+Study
C	1210 sq.ft.	2BHK+2T

S.No.	FLOOR	FLAT NO.	TYPE	AREA SQ.FT.	FLOOR PLC	GREEN PLC	STATUS	CUSTOMER NAME
01	Ground	001	A	1730	✓	✓		
02		002	A	1730	✓			
03		004	C	1210	✓			
04	1st Floor	101	A	1730	✓	✓		
05		102	A	1730	✓			
06		103	B	1465	✓	✓	PSL	
07		104	C	1210	✓			
08	2nd Floor	201	A	1730	✓	✓		
09		202	A	1730	✓			
10		203	B	1465	✓	✓		
11		204	C	1210	✓			
12	3rd Floor	301	A	1730	✓	✓		
13		302	A	1730	✓			
14		303	B	1465	✓	✓		
15		304	C	1210	✓			
16	4th Floor	401	A	1730	✓	✓		
17		402	A	1730	✓		PSL	
18		403	B	1465	✓	✓	PSL	
19		404	C	1210	✓			
20	5th Floor	501	A	1730	✓	✓		
21		502	A	1730	✓			
22		503	B	1465	✓	✓		
23		504	C	1210	✓			
24	6th Floor	601	A	1730	✓	✓		
25		602	A	1730	✓			
26		603	B	1465	✓	✓		
27		604	C	1210	✓			

S.No.	FLOOR	FLAT NO.	TYPE	AREA SQ.FT.	FLOOR PLC	GREEN PLC	STATUS	CUSTOMER NAME
28	7th Floor	701	A	1730	✓	✓	PSL	
29		702	A	1730	✓		PSL	
30		703	B	1465	✓	✓		
31		704	C	1210	✓		PSL	
32	8th Floor	801	A	1730	✓	✓		
33		802	A	1730	✓			
34		803	B	1465	✓	✓		
35		804	C	1210	✓			
36	9th Floor	901	A	1730	✓	✓		
37		902	A	1730	✓			
38		903	B	1465	✓	✓		
39		904	C	1210	✓			
40	10th Floor	1001	A	1730	✓	✓	PSL	
41		1002	A	1730	✓		PSL	
42		1003	B	1465	✓	✓	PSL	
43		1004	C	1210	✓		PSL	
44	11th Floor	1101	A	1730		✓		
45		1102	A	1730				
46		1103	B	1465		✓		
47		1104	C	1210				
48	12th Floor	1201	A	1730		✓		
49		1202	A	1730				
50		1203	B	1465		✓		
51		1204	C	1210				
52	13th Floor	1301	A	1730		✓		
53		1302	A	1730				
54		1303	B	1465		✓		
55		1304	C	1210				

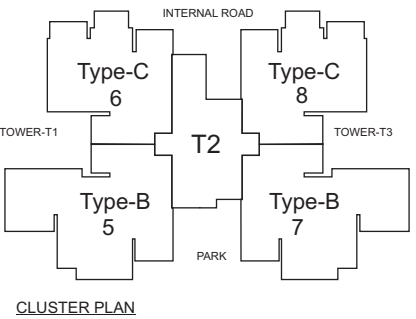
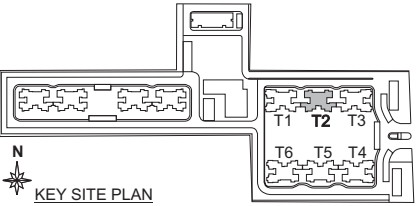

Type	Super Builtup Area	Accommodation
A	1730 sq.ft.	3BHK+3T
B	1465 sq.ft.	2BHK+2T+Study
C	1210 sq.ft.	2BHK+2T

S.No.	FLOOR	FLAT NO.	TYPE	AREA SQ.FT.	FLOOR PLC	GREEN PLC	STATUS	CUSTOMER NAME
	Ground							
01		006	C	1210	✓			
02		008	C	1210	✓			
03	1st Floor	105	B	1465	✓	✓		
04		106	C	1210	✓			
05		107	B	1465	✓	✓		
06		108	C	1210	✓			
07	2nd Floor	205	B	1465	✓	✓		
08		206	C	1210	✓			
19		207	B	1465	✓	✓		
10		208	C	1210	✓			
11	3rd Floor	305	B	1465	✓	✓		
12		306	C	1210	✓			
13		307	B	1465	✓	✓		
14		308	C	1210	✓			
15	4th Floor	405	B	1465	✓	✓		
16		406	C	1210	✓			
17		407	B	1465	✓	✓		
18		408	C	1210	✓			
19	5th Floor	505	B	1465	✓	✓		
20		506	C	1210	✓			
21		507	B	1465	✓	✓		
22		508	C	1210	✓			
23	6th Floor	605	B	1465	✓	✓		
24		606	C	1210	✓			
25		607	B	1465	✓	✓		
26		608	C	1210	✓			
27	7th Floor	705	B	1465	✓	✓	PSL	
28		706	C	1210	✓		PSL	
29		707	B	1465	✓	✓	PSL	
30		708	C	1210	✓		PSL	
31	8th Floor	805	B	1465	✓	✓		
32		806	C	1210	✓			
33		807	B	1465	✓	✓		
34		808	C	1210	✓			

S.No.	FLOOR	FLAT NO.	TYPE	AREA SQ.FT.	FLOOR PLC	GREEN PLC	STATUS	CUSTOMER NAME
35	9th Floor	905	B	1465	✓	✓		
36		906	C	1210	✓			
37		907	B	1465	✓	✓		
38		908	C	1210	✓			
39	10th Floor	1005	B	1465	✓	✓	PSL	
40		1006	C	1210	✓		PSL	
41		1007	B	1465	✓	✓	PSL	
42		1008	C	1210	✓		PSL	
43	11th Floor	1105	B	1465		✓		
44		1106	C	1210				
45		1107	B	1465		✓		
46		1108	C	1210				
47	12th Floor	1205	B	1465		✓		
48		1206	C	1210				
49		1207	B	1465		✓		
50		1208	C	1210				
51	13th Floor	1305	B	1465		✓		
52		1306	C	1210				
53		1307	B	1465		✓		
54		1308	C	1210				
55	14th Floor	1405	B	1465		✓	PSL	
56		1406	C	1210			PSL	
57		1407	B	1465		✓		
58		1408	C	1210				
59	15th Floor	1505	B	1465		✓	PSL	
60		1506	C	1210			PSL	
61		1507	B	1465		✓		
62		1508	C	1210				
63	16th Floor	1605	B	1465		✓		
64		1606	C	1210				
65		1607	B	1465		✓		
66		1608	C	1210				
67	17th Floor	1705	B	1465		✓		
68		1706	C	1210				
69		1707	B	1465		✓		
70		1708	C	1210				

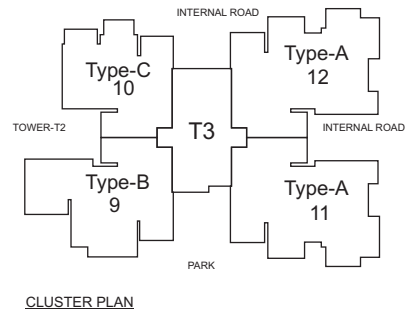
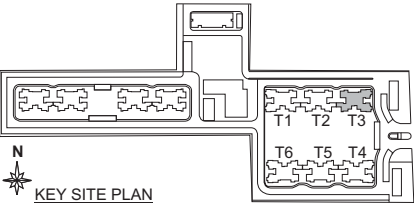

Type	Super Builtup Area	Accommodation
A	1730 sq.ft.	3BHK+3T
B	1465 sq.ft.	2BHK+2T+Study
C	1210 sq.ft.	2BHK+2T

S.No.	FLOOR	FLAT NO.	TYPE	AREA SQ.FT.	FLOOR PLC	GREEN PLC	STATUS	CUSTOMER NAME
	Ground							
01		010	C	1210	✓			
02		011	A	1730	✓	✓		
03		012	A	1730	✓			
04	1st Floor	109	B	1465	✓	✓		
05		110	C	1210	✓			
06		111	A	1730	✓	✓		
07		112	A	1730	✓			
08	2nd Floor	209	B	1465	✓	✓		
09		210	C	1210	✓			
10		211	A	1730	✓	✓		
11		212	A	1730	✓			
12	3rd Floor	309	B	1465	✓	✓		
13		310	C	1210	✓			
14		311	A	1730	✓	✓		
15		312	A	1730	✓			
16	4th Floor	409	B	1465	✓	✓		
17		410	C	1210	✓			
18		411	A	1730	✓	✓		
19		412	A	1730	✓			
20	5th Floor	509	B	1465	✓	✓		
21		510	C	1210	✓			
22		511	A	1730	✓	✓		
23		512	A	1730	✓			
24	6th Floor	609	B	1465	✓	✓		
25		610	C	1210	✓			
26		611	A	1730	✓	✓		
27		612	A	1730	✓			

S.No.	FLOOR	FLAT NO.	TYPE	AREA SQ.FT.	FLOOR PLC	GREEN PLC	STATUS	CUSTOMER NAME
28	7th Floor	709	B	1465	✓	✓	PSL	
29		710	C	1210	✓			
30		711	A	1730	✓	✓	PSL	
31		712	A	1730	✓		PSL	
32	8th Floor	809	B	1465	✓	✓		
33		810	C	1210	✓			
34		811	A	1730	✓	✓		
35		812	A	1730	✓			
36	9th Floor	909	B	1465	✓	✓		
37		910	C	1210	✓			
38		911	A	1730	✓	✓		
39		912	A	1730	✓			
40	10th Floor	1009	B	1465	✓	✓		
41		1010	C	1210	✓		PSL	
42		1011	A	1730	✓	✓	PSL	
43		1012	A	1730	✓		PSL	
44	11th Floor	1109	B	1465		✓		
45		1110	C	1210				
46		1111	A	1730		✓		
47		1112	A	1730				
48	12th Floor	1209	B	1465		✓		
49		1210	C	1210				
50		1211	A	1730		✓		
51		1212	A	1730				
52	13th Floor	1309	B	1465		✓		
53		1310	C	1210				
54		1311	A	1730		✓		
55		1312	A	1730				

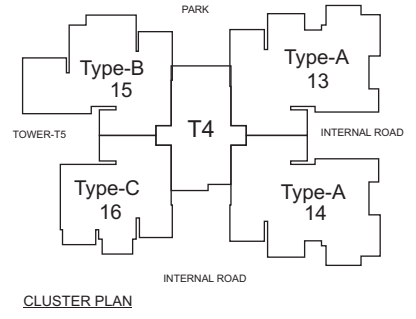
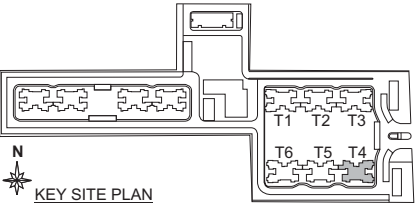

Type	Super Builtup Area	Accommodation
A	1730 sq.ft.	3BHK+3T
B	1465 sq.ft.	2BHK+2T+Study
C	1210 sq.ft.	2BHK+2T

S.No.	FLOOR	FLAT NO.	TYPE	AREA SQ.FT.	FLOOR PLC	GREEN PLC	STATUS	CUSTOMER NAME
01	Ground	013	A	1730	✓	✓		
02		014	A	1730	✓			
03		016	C	1210	✓			
04	1st Floor	113	A	1730	✓	✓		
05		114	A	1730	✓			
06		115	B	1465	✓	✓		
07		116	C	1210	✓			
08	2nd Floor	213	A	1730	✓	✓		
09		214	A	1730	✓			
10		215	B	1465	✓	✓		
11		216	C	1210	✓			
12	3rd Floor	313	A	1730	✓	✓		
13		314	A	1730	✓			
14		315	B	1465	✓	✓		
15		316	C	1210	✓			
16	4th Floor	413	A	1730	✓	✓		
17		414	A	1730	✓			
18		415	B	1465	✓	✓		
19		416	C	1210	✓			
20	5th Floor	513	A	1730	✓	✓		
21		514	A	1730	✓			
22		515	B	1465	✓	✓		
23		516	C	1210	✓			
24	6th Floor	613	A	1730	✓	✓		
25		614	A	1730	✓			
26		615	B	1465	✓	✓		
27		616	C	1210	✓			

S.No.	FLOOR	FLAT NO.	TYPE	AREA SQ.FT.	FLOOR PLC	GREEN PLC	STATUS	CUSTOMER NAME
28	7th Floor	713	A	1730	✓	✓		
29		714	A	1730	✓			
30		715	B	1465	✓	✓		
31		716	C	1210	✓			
32	8th Floor	813	A	1730	✓	✓		
33		814	A	1730	✓			
34		815	B	1465	✓	✓		
35		816	C	1210	✓			
36	9th Floor	913	A	1730	✓	✓		
37		914	A	1730	✓			
38		915	B	1465	✓	✓		
39		916	C	1210	✓			
40	10th Floor	1013	A	1730	✓	✓	PSL	
41		1014	A	1730	✓		PSL	
42		1015	B	1465	✓	✓	PSL	
43		1016	C	1210	✓		PSL	
44	11th Floor	1113	A	1730		✓		
45		1114	A	1730				
46		1115	B	1465		✓		
47		1116	C	1210				
48	12th Floor	1213	A	1730		✓		
49		1214	A	1730				
50		1215	B	1465		✓		
51		1216	C	1210				
52	13th Floor	1313	A	1730		✓		
53		1314	A	1730				
54		1315	B	1465		✓		
55		1316	C	1210				

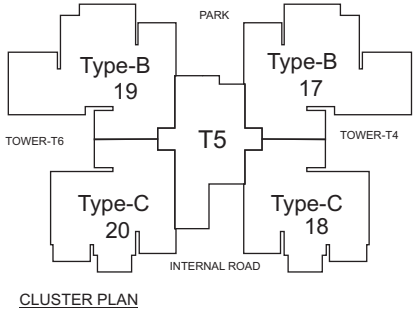
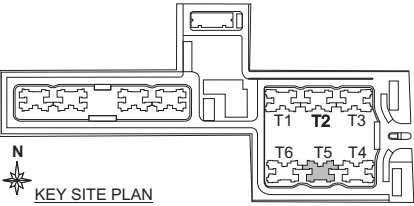

Type	Super Builtup Area	Accommodation
A	1730 sq.ft.	3BHK+3T
B	1465 sq.ft.	2BHK+2T+Study
C	1210 sq.ft.	2BHK+2T

S.No.	FLOOR	FLAT NO.	TYPE	AREA SQ.FT.	FLOOR PLC	GREEN PLC	STATUS	CUSTOMER NAME
	Ground							
01		018	C	1210	✓			
02		020	C	1210	✓			
03	1st Floor	117	B	1465	✓	✓	PSL	
04		118	C	1210	✓			
05		119	B	1465	✓	✓		
06		120	C	1210	✓			
07	2nd Floor	217	B	1465	✓	✓		
08		218	C	1210	✓			
19		219	B	1465	✓	✓		
10		220	C	1210	✓			
11	3rd Floor	317	B	1465	✓	✓		
12		318	C	1210	✓			
13		319	B	1465	✓	✓		
14		320	C	1210	✓			
15	4th Floor	417	B	1465	✓	✓		
16		418	C	1210	✓		PSL	
17		419	B	1465	✓	✓		
18		420	C	1210	✓		PSL	
19	5th Floor	517	B	1465	✓	✓		
20		518	C	1210	✓			
21		519	B	1465	✓	✓		
22		520	C	1210	✓			
23	6th Floor	617	B	1465	✓	✓		
24		618	C	1210	✓			
25		619	B	1465	✓	✓		
26		620	C	1210	✓			
27	7th Floor	717	B	1465	✓	✓	PSL	
28		718	C	1210	✓		PSL	
29		719	B	1465	✓	✓	PSL	
30		720	C	1210	✓		PSL	
31	8th Floor	817	B	1465	✓	✓		
32		818	C	1210	✓			
33		819	B	1465	✓	✓		
34		820	C	1210	✓			

S.No.	FLOOR	FLAT NO.	TYPE	AREA SQ.FT.	FLOOR PLC	GREEN PLC	STATUS	CUSTOMER NAME
35	9th Floor	917	B	1465	✓	✓		
36		918	C	1210	✓			
37		919	B	1465	✓	✓		
38		920	C	1210	✓			
39	10th Floor	1017	B	1465	✓	✓	PSL	
40		1018	C	1210	✓			
41		1019	B	1465	✓	✓	PSL	
42		1020	C	1210	✓			
43	11th Floor	1117	B	1465		✓		
44		1118	C	1210				
45		1119	B	1465		✓		
46		1120	C	1210				
47	12th Floor	1217	B	1465		✓		
48		1218	C	1210				
49		1219	B	1465		✓		
50		1220	C	1210				
51	13th Floor	1317	B	1465		✓		
52		1318	C	1210				
53		1319	B	1465		✓		
54		1320	C	1210				
55	14th Floor	1417	B	1465		✓	PSL	
56		1418	C	1210			PSL	
57		1419	B	1465		✓		
58		1420	C	1210				
59	15th Floor	1517	B	1465		✓		
60		1518	C	1210			PSL	
61		1519	B	1465		✓	PSL	
62		1520	C	1210			PSL	
63	16th Floor	1617	B	1465		✓		
64		1618	C	1210				
65		1619	B	1465		✓		
66		1620	C	1210				
67	17th Floor	1717	B	1465		✓		
68		1718	C	1210				
69		1719	B	1465		✓		
70		1720	C	1210				

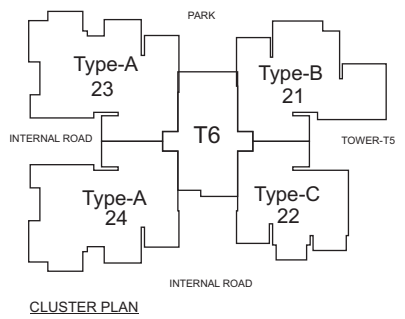
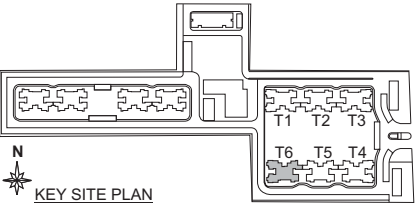

Type	Super Builtup Area	Accommodation
A	1730 sq.ft.	3BHK+3T
B	1465 sq.ft.	2BHK+2T+Study
C	1210 sq.ft.	2BHK+2T

S.No.	FLOOR	FLAT NO.	TYPE	AREA SQ.FT.	FLOOR PLC	GREEN PLC	STATUS	CUSTOMER NAME
	Ground							
01		022	C	1210	✓			
02		023	A	1730	✓	✓		
03		024	A	1730	✓			
04	1st Floor	121	B	1465	✓	✓		
05		122	C	1210	✓			
06		123	A	1730	✓	✓		
07		124	A	1730	✓			
08	2nd Floor	221	B	1465	✓	✓		
09		222	C	1210	✓			
10		223	A	1730	✓	✓		
11		224	A	1730	✓			
12	3rd Floor	321	B	1465	✓	✓		
13		322	C	1210	✓			
14		323	A	1730	✓	✓		
15		324	A	1730	✓			
16	4th Floor	421	B	1465	✓	✓		
17		422	C	1210	✓			
18		423	A	1730	✓	✓		
19		424	A	1730	✓			
20	5th Floor	521	B	1465	✓	✓		
21		522	C	1210	✓			
22		523	A	1730	✓	✓		
23		524	A	1730	✓			
24	6th Floor	621	B	1465	✓	✓		
25		622	C	1210	✓			
26		623	A	1730	✓	✓		
27		624	A	1730	✓			

S.No.	FLOOR	FLAT NO.	TYPE	AREA SQ.FT.	FLOOR PLC	GREEN PLC	STATUS	CUSTOMER NAME
28	7th Floor	721	B	1465	✓	✓	PSL	
29		722	C	1210	✓		PSL	
30		723	A	1730	✓	✓	PSL	
31		724	A	1730	✓		PSL	
32	8th Floor	821	B	1465	✓	✓		
33		822	C	1210	✓			
34		823	A	1730	✓	✓		
35		824	A	1730	✓			
36	9th Floor	921	B	1465	✓	✓		
37		922	C	1210	✓			
38		923	A	1730	✓	✓		
39		924	A	1730	✓			
40	10th Floor	1021	B	1465	✓	✓		
41		1022	C	1210	✓			
42		1023	A	1730	✓	✓		
43		1024	A	1730	✓			
44	11th Floor	1121	B	1465		✓		
45		1122	C	1210				
46		1123	A	1730		✓	PSL	
47		1124	A	1730			PSL	
48	12th Floor	1221	B	1465		✓	PSL	
49		1222	C	1210				
50		1223	A	1730		✓		
51		1224	A	1730				
52	13th Floor	1321	B	1465		✓		
53		1322	C	1210				
54		1323	A	1730		✓		
55		1324	A	1730				